

# Colne Marina



## Design

Morgan Marine aspires to further develop its existing marina and facilities into the 'Colne Marina'. The aim of the development is to expand and modernise the facilities, incorporate environmental best practice, and benefit the local business community, which is within easy walking distance of the redevelopment site, helping to attract more visitors to the area.

The development will include:

- A redesign of the moorings with a focus on higher quality
- Modernisation of services such as WIFI and washroom facilities
- Haulage services
- Shore side vessel services such as maintenance
- Bunded, environmentally-considerate washdown facility
- Safe and secure boat storage

## West Basin Design

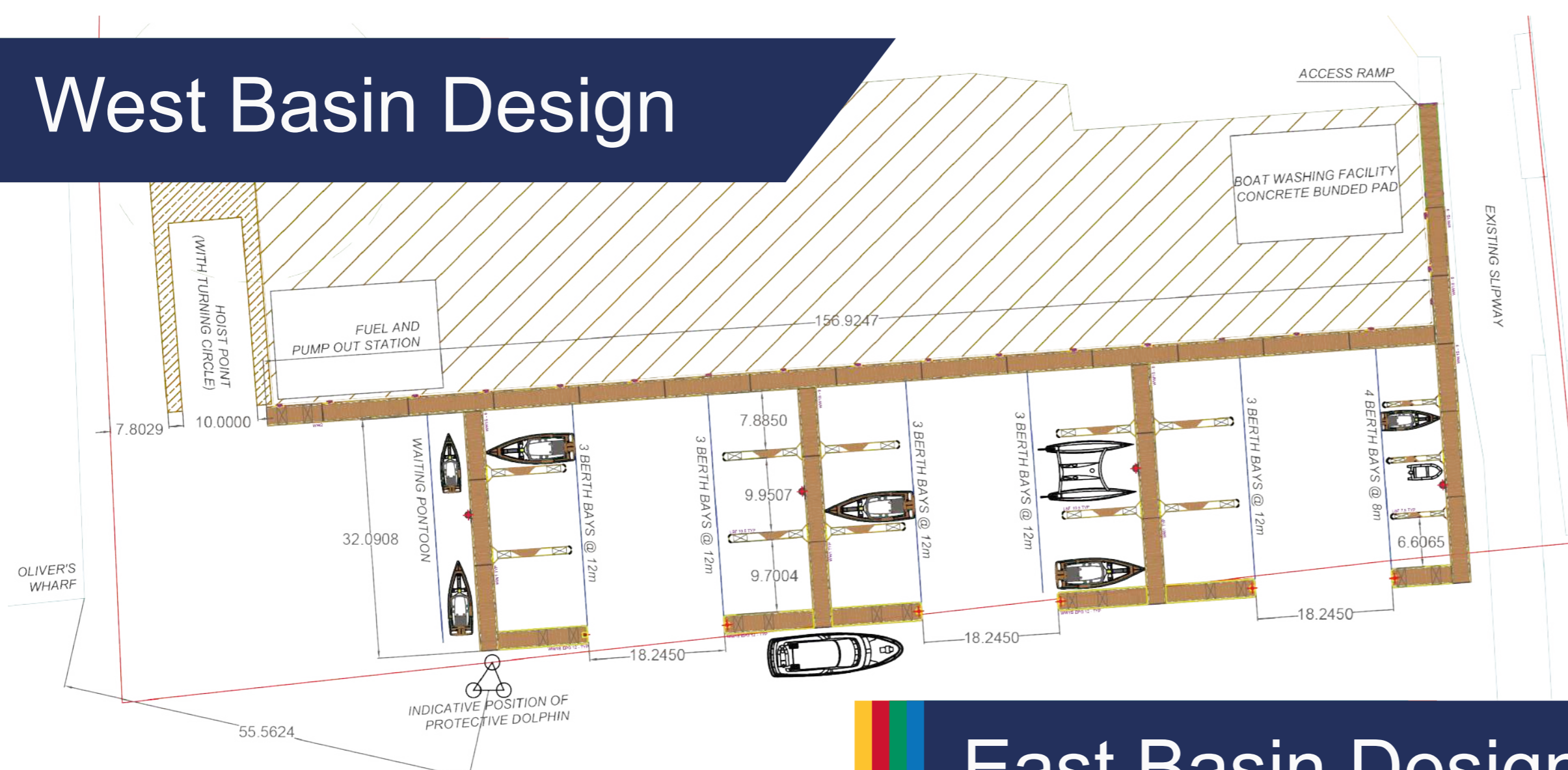

## East Basin Design

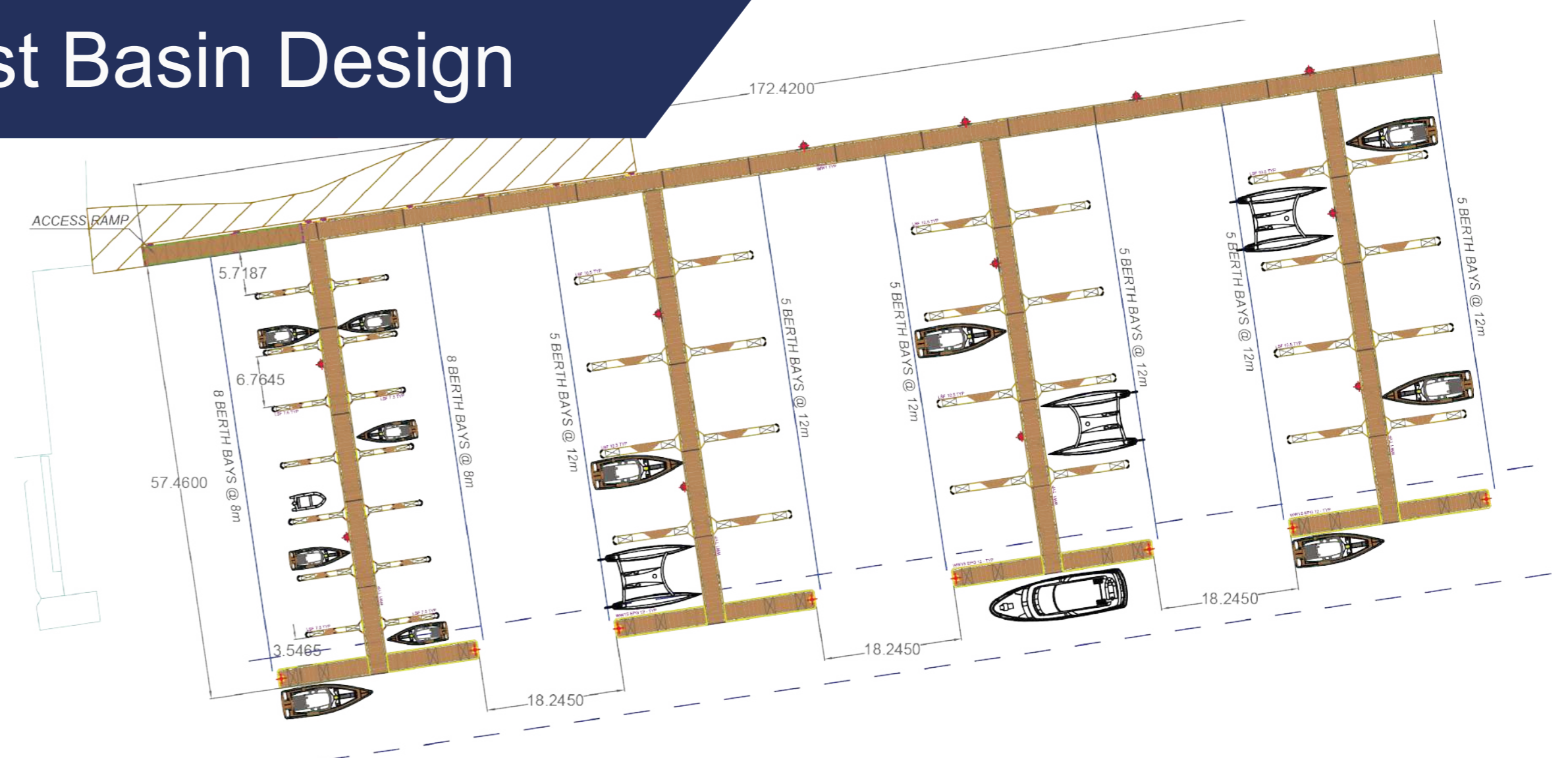

As part of the development, Colne Marina will see the addition of 25 new moorings and the reconfiguration of 90 existing moorings with approximately 275m of new piling in the west basin and 105m in the east basin will be constructed. This new piling will replace the rotted and decrepit telephone poles, to increase site security and longevity.

The development will bring a fresh, new and visually appealing waterfront. As well as improving the aesthetics of the Cindery vicinity, the regeneration will compliment the existing work of Brightlingsea Harbour Commissioners in the Waterside area, thereby helping to bring modern and innovative designs to the whole of Brightlingsea.